

# EduMic Compatibility Guide

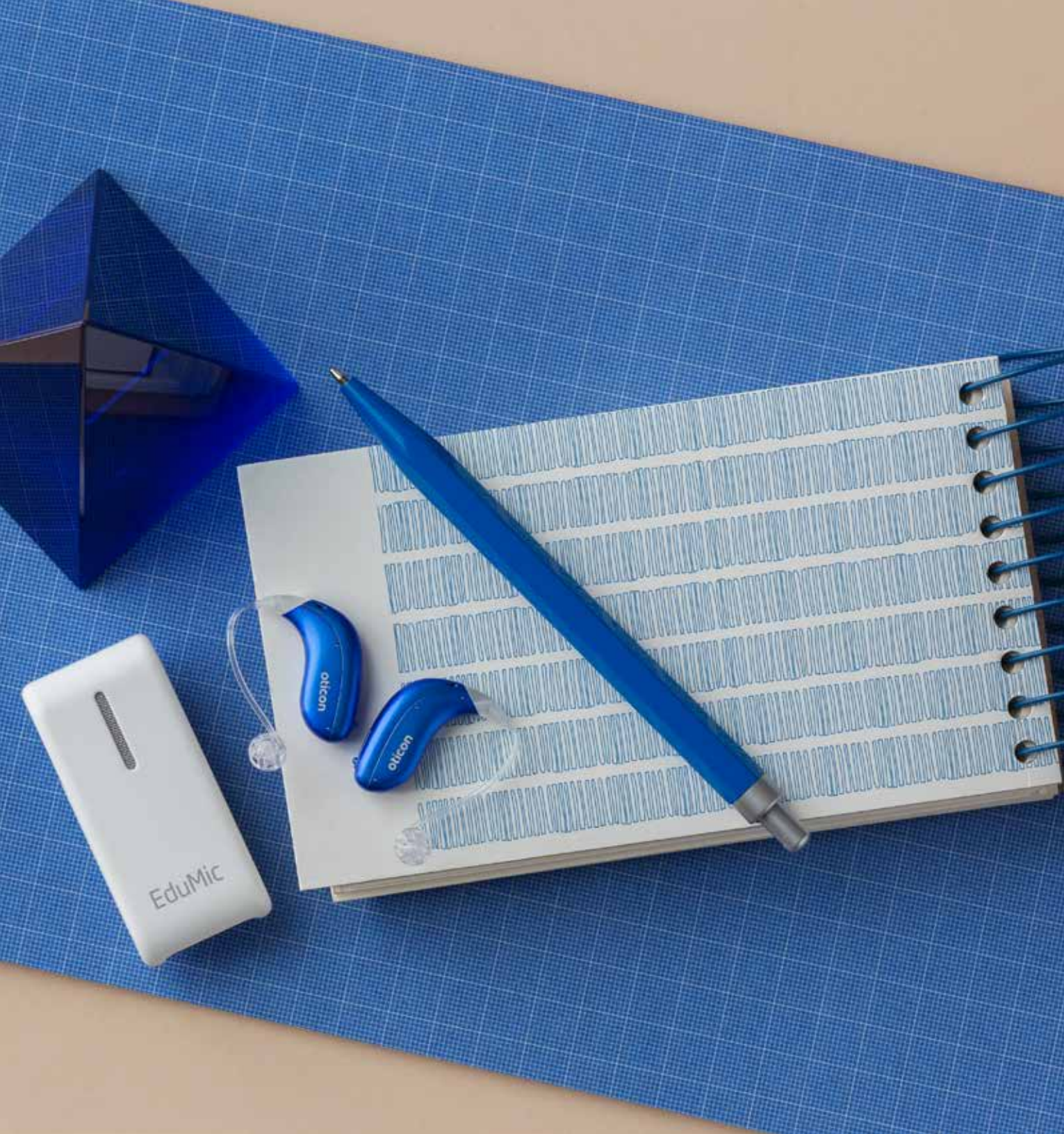

# EduMic Compatibility Guide

This guide provides use case scenarios for EduMic coupled with Oticon hearing aids, as well as other hearing aid, wireless microphone and FM brands.

Scenario Description	Technology Description	Hearing Aids	Model
<b>Scenario 1</b> <b>Oticon Bluetooth compatible products</b> Speaker wears EduMic. Listener(s) wear Oticon Bluetooth hearing aids.	EduMic streams directly to Oticon Bluetooth hearing aids.	Oticon Play PX, Opn Play, Xceed Play, Oticon More™, Opn S™, Opn™, Xceed, Zircon, Ruby, Siya, Oticon Medical Ponto 4 or later and future Bluetooth hearing aids from Oticon	miniBTE R, miniBTE T, BTE PP, miniRITE R, miniRITE T, miniRITE, BTE, Ultra Power, Super Power and Ponto 4 or later
<b>Scenario 2</b> <b>Oticon hearing aids with varying Oticon technology</b> Speaker wears Oticon Amigo T30 or T31 transmitter system. Listener(s) wear older Oticon or Oticon Bluetooth hearing aids.	For listener(s) wearing older Oticon hearing aids, the Amigo R12 Receiver is plugged into the hearing aid.	Oticon Sensei, Sensei SP, Dynamo, Ponto 3 + Streamer	BTE, Power BTE, Super Power BTE
	For listener(s) wearing Oticon Bluetooth hearing aids, the Amigo R2 Universal Receiver is plugged into the EduMic. The EduMic is placed on a table. Listeners sit no more than 9.5 feet away from the EduMic.	Oticon Play PX, Opn Play, Xceed Play, Oticon More, Opn S, Opn, Xceed, Zircon, Ruby, Siya, Oticon Medical Ponto 4 or later and future Bluetooth hearing aids from Oticon	miniBTE R, miniBTE T, BTE PP, miniRITE R, miniRITE T, miniRITE, BTE, Ultra Power, Super Power and Ponto 4 or later
	For non-Bluetooth hearing aids, please contact Oticon		BTE models, miniRITE T, miniRITE
<b>Scenario 3</b> <b>EduMic with Roger Touchscreen Mic when universal receiver is available</b> Speaker wears Phonak Roger Touchscreen Mic.	For listener(s) wearing Oticon Bluetooth hearing aids, the Roger X Universal Receiver is plugged into the EduMic.	Oticon Play PX, Opn Play, Xceed Play, Oticon More, Opn S, Opn, Xceed, Zircon, Ruby, Siya, Oticon Medical Ponto 4 or later and future Bluetooth hearing aids from Oticon	miniBTE R, miniBTE T, BTE PP, miniRITE R, miniRITE T, miniRITE, BTE, Ultra Power, Super Power and Ponto 4 or later
	For listener(s) wearing Phonak hearing aids, Roger transmits directly to the aids.	Phonak hearing aids	
	For listener(s) wearing non-Bluetooth Oticon hearing aids, use Roger receiver. Receiver model is based on make and model of hearing aid. Receiver is plugged into the hearing aid.	Oticon Sensei, Dynamo or older, Ponto 3	BTE, Power BTE, Super Power BTE
<b>Scenario 4</b> <b>EduMic with Roger Touchscreen Mic when a universal receiver is not available</b> Speaker wears both EduMic and a Phonak Roger Touchscreen Mic	For listener(s), EduMic streams directly to Oticon Bluetooth hearing aids, while Roger transmits directly to Phonak hearing aids. It is an option when a universal receiver is not available.	Oticon Play PX, Opn Play, Xceed Play, Oticon More, Opn S, Opn, Xceed, Zircon, Ruby, Siya, Oticon Medical Ponto 4 or later and future Bluetooth hearing aids from Oticon	miniBTE R, miniBTE T, BTE PP, miniRITE R, miniRITE T, miniRITE, BTE, Ultra Power, Super Power and Ponto 4 or later
<b>Scenario 5</b> <b>EduMic with FrontRow Juno</b> Speaker wears Juno transmitter. The AUX volume on Juno Tower is set to Maximum. EduMic is connected via 3.5 mm audio cable to audio out jack on Juno Tower.	For listener(s) wearing Oticon Bluetooth hearing aids, the voice is transmitted directly to the hearing aids.	Oticon Play PX, Opn Play, Xceed Play, Oticon More, Opn S, Opn, Xceed, Zircon, Ruby, Siya, Oticon Medical Ponto 4 or later and future Bluetooth hearing aids from Oticon	miniBTE R, miniBTE T, BTE PP, miniRITE R, miniRITE T, miniRITE, BTE, Ultra Power, Super Power and Ponto 4 or later
	For listener(s) not wearing hearing aids, the sound is amplified as usual.	For listener(s) not wearing hearing aids, the sound is amplified as usual.	

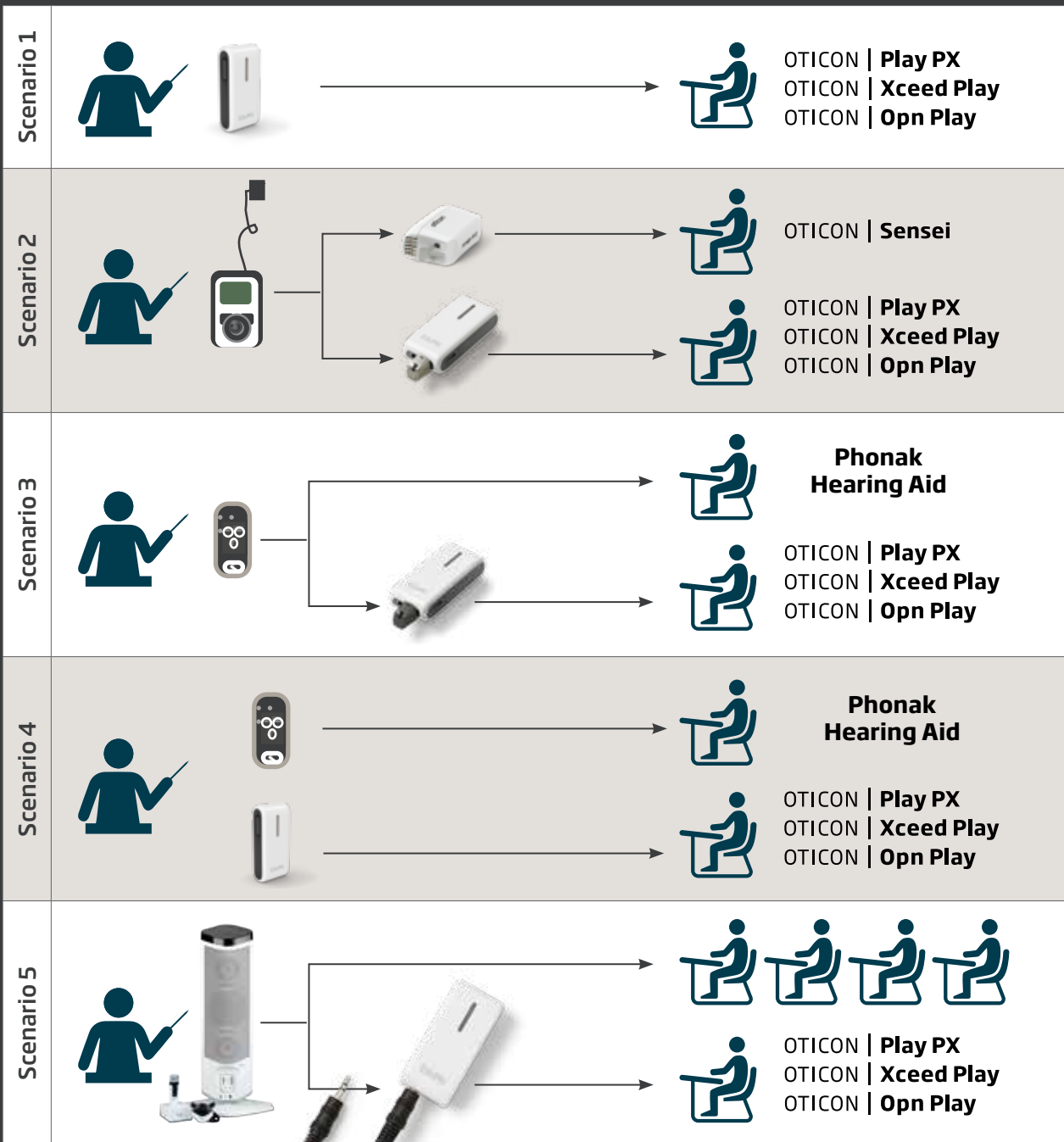

**Important Note:** For information on the LED light indicators on the hearing aids, please refer to the instructions for use for the hearing aids.

### LED indicator overview



#### Status indicator

A steady light indicates you are sending sound. A flashing light indicates that EduMic is muted.

○	White	Start-up
⦿	Flashing blue	Pairing in progress
●	Green	ON/microphone mode
⦿	Flashing green	Mute in microphone mode
●	Yellow	Jack/FM mode
⦿	Flashing yellow	Mute in jack/FM mode
●	Red	Pairings cleared
●	Magenta	Telecoil mode
⦿	Flashing magenta	Mute in telecoil mode

### LED indicator overview



#### Power indicator

Charging time for full charging is 2.5 hours. A quick 30 minute charge during a break provides approx. 2.5 hours of use.

When the power indicator flashes RED, there is approx. 2 hours of battery life remaining.

○	White	Start-up
●	Green	Fully charged
⦿	Flashing yellow	Charging
⦿	Flashing red	Battery low

# Oticon Hearing Aid Connectivity Chart

What Oticon hearing aid technology does the student have?

Oticon Hearing Aid Connectivity Chart			
Family	Ear-Level Option	Telecoil	EduMic
<b>Oticon Play PX</b>			
miniBTE R or miniBTE T		▪	▪
miniRITE R or miniRITE T		▪	▪
<b>Oticon More™</b>			
miniBTE R or miniBTE T		▪	▪
miniRITE R or miniRITE T		▪	▪
<b>Zircon</b>			
miniBTE R or miniBTE T		▪	▪
miniRITE R or miniRITE T		▪	▪
<b>Opn Play, Xceed Play, and Xceed</b>			
Opn Play BTE PP or Xceed Play/Xceed BTE SP and UP	FM battery door + FM10	▪	▪
Opn Play miniRITE R or miniRITE T		▪	▪
Opn Play miniRITE			▪
<b>Oticon Opn S™ and Opn™</b>			
Opn S/Opn BTE PP	FM battery door + FM10	▪	▪
Opn S/Opn miniRITE R or miniRITE T		▪	▪
Opn S/Opn miniRITE			▪
<b>Ruby and Siya</b>			
Ruby and Siya BTE or BTE PP	FM battery door + FM10	▪	▪
Ruby and Siya miniRITE R or miniRITE T		▪	▪
Ruby and Siya miniRITE			▪
<b>Other</b>			
Ponto 4 or later			▪
Ponto 3, P, SP	With Streamer Pro		
Sensei 13BTE/SP	With FM9	▪	
Inium Sense Power Plus	With FM10	▪	

18508 15555-9915/01.22



oticon.com