

ConnectClip

Quick Start Guide

PAIRING CONNECTCLIP WITH HEARING AIDS

1. **Ensure ConnectClip is powered off.** Press and hold multi-button for approximately 6 seconds until power indicator OFF ●
2. **Turn both hearing aids OFF and back ON.**
(Please see the Instructions For Use-Turn hearing aids ON/OFF for your device)
3. **The hearing aids will now be ready** for first time connection with the ConnectClip. You now have 3 minutes to complete the pairing.
4. **Turn ON ConnectClip.** Press and hold multi-button for approximately 3 seconds until power indicator shows STEADY GREEN ●
5. **ConnectClip will now search for your hearing aids.** Status indicator BLINKING YELLOW ●
6. **Place ConnectClip and both hearing aids close to each other** (maximum distance is 8 inches)
7. **Connection established with hearing aid(s)** is indicated by status indicator STEADY YELLOW ●

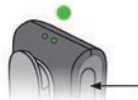
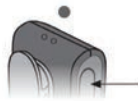

PAIRING CONNECTCLIP WITH MOBILE PHONE

1. **Pair the ConnectClip with your hearing aids before pairing ConnectClip with your mobile phone.**
2. **Place ConnectClip in Pairing mode.** Press and hold the multi-button AND volume up button for about 6 seconds (A) until status BLINKS BLUE ●
3. **Enable pairing on mobile phone.** Turn on Bluetooth. Search for and connect to/pair with ConnectClip
This is normally in the Settings/Bluetooth section of your phone
4. **Enter your pin code.** If your phone requests a pin code enter 0000 (four zeros).
5. **Pairing complete.** Pairing complete with mobile phone is indicated by status STEADY BLUE ●

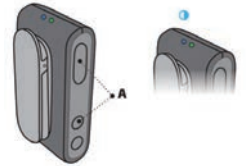

RECEIVING CALLS

Phone connected: When the ConnectClip is turned on and is in range of your mobile phone it will automatically connect to the mobile phone. The status indicator is STEADY BLUE ●



Phone ringing: When the phone rings you will hear a ring indicator (and, if available, the ring-tone from your phone) in your hearing aids. The status indicator will BLINK GREEN ●



Answer call: Either a short press of the multi-button (A) – or answer the call from your mobile phone.

Once the call is connected status will change to STEADY GREEN ●



End call: Either a short press of the multi-button (A) – or hang up the call from your mobile phone. Status STEADY BLUE ●



LISTENING TO MUSIC

If connected to a mobile phone or other paired device through Bluetooth, the music played on the phone/device will automatically be played in your hearing aids. STATUS ORANGE ●

You do not need to press any buttons or change anything on the ConnectClip.



REMOTE MICROPHONE

Press and hold multi-button for approximately 3 seconds to change mode. Mode change is confirmed by an audible indication in your hearing aids. STATUS MAGENTA ●

See "ConnectClip Quick Guide to the Remote Microphone" for more details.

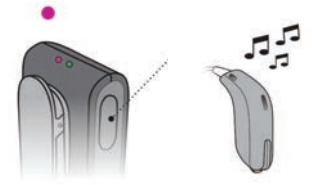

IMPORTANT: Ensure that the microphone is pointing to the speaker's mouth and that it is not covered by clothing, scarf, tie, etc.

REMOTE CONTROL

When ConnectClip is not streaming sound it doubles as a remote control for your hearing aids.



- **Volume up**
– short press
- **Volume down**
– short press



- **Next program**
– Press and hold for 3 seconds for next program
 - **Mute hearing aid microphones**
– long press on volume down button
- Short press volume up or down will **unmute**

IMPORTANT:

When used as a remote control, the maximum distance between ConnectClip and hearing aids is 6 feet.

Overview – ConnectClip blinking patterns

Status	Description	
●	Blinking yellow	Searching for hearing aids
●	Steady yellow	Hearing aids connected. Not connected to a phone.
●	Blinking blue	Searching for mobile phone (pairing)
●	Steady blue	Connected to a mobile phone
●	Steady green	On a call
●	Blinking green	Incoming call
●	Steady orange	Music, Mobile Phone
●	Steady magenta	Remote microphone mode
●	Blinking magenta	Remote microphone reconnecting

Power	Description	
●	Steady red	Battery low
●	Steady green	Turned on – not charging
●	Blinking green	Turned on – charging
●	Fading green	Turned on – charging complete
●	Blinking orange	Turned off – charging
●	Steady orange	Turned off – charging complete

14242 1555-10192 / 06.22

